

## ii) ARISTON



-  
-  
-

1  
- i 1 3 II'  
- 1  
- nepenik cepBicHHx 1

Electric water heaters

- 1.
- 2.
- 3.
- 4.
- 5.
- 6.
- 7.
- 8.
- 9.
- 10.
- 11.
- 12.
- 13.
- 14.
- 15.

	> ^

1			
2			
3			
4			
5			

>

6			
7			
8			
9	^	^	

10			
11	0( )	1^	
12			

	0 353					0 450				
	30	40	50	65	80	50	80	100	120	150
	15	17	19	21	25	17	22	26	33	41

/89/336

2468-011-11182725-2006.

( )

! 1

»!]< 1

( )-

(V)

< )

( . 1 . II).

50 ,

10 ( . II).

$\frac{12}{2}$   $\frac{4}{4}$  ( . 111).

80°

( . IV)

0,7 (7 ).

( . IV)

3-4

0°

( 5 ),

( 12° ).

)-----

( 05\ /- 3x1,5 , 0 8,5 ).  
( , 3-4-5-6).

1-

2-

3

3-4-5-6).

)

(

^(

( 05\ /- 3x1,5 ^, 0 8,5 ),  
. 3-4-5-6.

(

)

!

(

);

( .2 .IV)

!

( . ),  
( . ),  
( . ),

3 5:

( . )

( . ),  
( . )

4 6:

( . ),

( . ),

( . ¥, ) ( . \^), ( o . Z), ( . V)

(8. .7), ( .8). ( .7), 5 ( .8). ( .7 8). (Z .9)

( .9). 1-2 ( .30%)

( )

50°

3 4:

( . )

-----

5 : 0 ( . )

( .1-5)

.1- ;

.2- ( NTC1/NTC2 ( ) );

.3- ;

.5- ;

.4 5- ( ) ;

.3 5- ;

.3,4 5- ;

0 ( . ) 25

5 6:

( , 01)

01- 02- 03- ;

10- 11- 12- 13- 16- ; NTC ( ) ;

04- ;

14- 15- ;

50- 51- ;

60- 90- 91- 92- ;

0 ( . ) .

( / 5 6)

«set» 2

«set».

3 4:

0 ( . ) .

«+» «-».

( .1-5), 40° 80° .

) (

), (

70° .

( . ) .

Manual ( ), 1 ( ), 2 ( )

0 ( . ) . 5 6:

( 2), «mode», 1 ( 4 ) 2 :

( ) 1) 2 ( ) 2) 1+ 2 ( ) 1 ) 2 ) Manual  
( ) ). 1 2 07:00 19:00

70° .  
«Manual» ( «Manual») «set»  
(

40° 80° ). «Manual» ( )

ECO: «Manual» ( ) ECO ( )

« ECO»),  
«set»  
«ECO» 3

«ECO». « 1» ( « 1»); « 1»), « 2» ( « 2»);  
« 2»), « 1» « 2» ( « 1» « 2») 1 ;  
( « 1» « 2» )  
«mode» )

«set», ( «set», 30 )

«set», ( 40° 80° ). «set», « 1+ 2»,

« 1» « 2»

( « 1», « 2» « 1+ 2»), «set»  
3 « ».

ECO PLUS: « ECO»), «set»,  
( « 1», « 2» « 1+ 2») ECO»),

3 «PLUS». «set»,

NBI

5

EXTRA POWER ( )  
4 6

EXTRA POWER

( . )

ECO  
ECO

3

: 6-12

70° .



>

ECO 24

ECO

ECO

NB!

ECO

ECO.

ECO

30

70'

^

.3 4:

ECO

70' ( .3 4)

«ECO» «+»;

.1 ( .3 4).

.2 ( . 4).

.5 6:

ECO

«-Ab-».

/  
) « » ( ), «mode» (« »). «8 ( « » ( »),

- )

-  
-  
-

-  
-  
-  
-  
-  
-  
- )

6...8

5

( )-

3468-011-11182725-2006

(495) 213 03 00, e-mail: service.ru@aristonthermo.com

: 188640,

4, 4, . / .

i

1

1

1

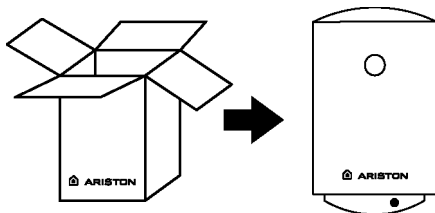

1 1 1



1

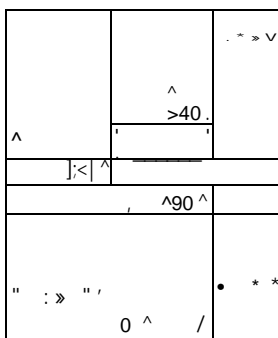

! !

&gt;51

1

\* \* \*

IV

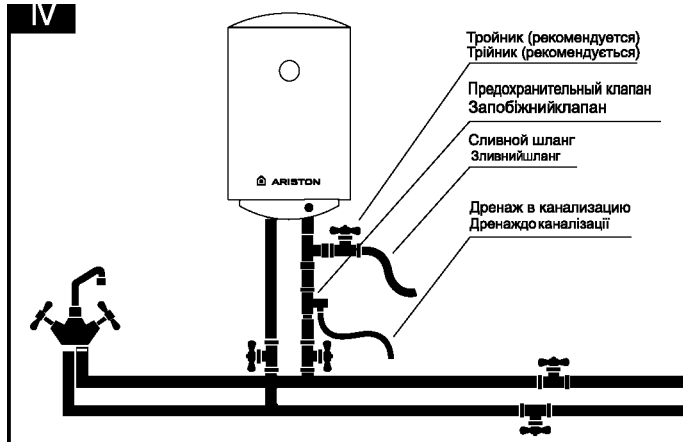

- Installation scheme

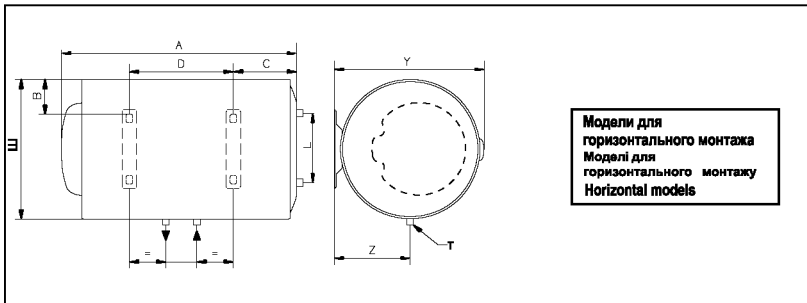
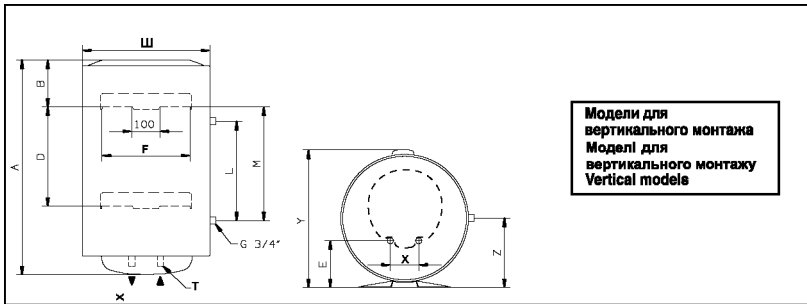

	MOD.				D	F	L		X	Y	Z		
353	30 V	588	145	-	-	96,5	310	-	-	100	383	·	G1/2"
	40 V	719	145	-	-	96,5	310	-	-	100	383	·	G1/2"
	50 V	837	145	-	-	96,5	310	-	-	100	383	·	G1/2"
	65 V	981	145	-	-	96,5	310	-	-	100	383	-	G1/2"
	80 V	1178	145	-	-	96,5	310	-	-	100	383	-	G1/2"
	30	588	64,5	141	242	-	310	-	-	100	383	196,5	G1/2"
	40	719	64,5	141	373	-	310	-	-	100	383	196,5	G1/2"
	50	837	64,5	141	491	-	310	-	-	100	383	196,5	G1/2"
	65	981	64,5	141	635	-	310	-	-	100	383	196,5	G1/2"
		1178	64,5	141	632	-	310	-	-	100	383	196,5	G1/2"
450	50V	553	163	-	-	165	310	-	·	100	480	-	G1/2"
	80V	758	163	-	-	165	310	·	·	100	480	·	G1/2"
	100V	913	166	-	-	165	310	·	·	100	480	-	G1/2"
	120V	1108	166	-	-	165	310	·	·	100	480	-	G1/2"
	150V	1338	164	-	944	165	310	·	·	100	480	-	G1/2"
	80	758	163	-	-	165	310	350	363	100	480	245	G1/2"
	100	913	166	-	-	165	310	350	363	100	480	245	G1/2"
	50	553	113	159	160	-	310	·	·	100	480	245	G1/2"
	80 /	758	113	174/19	335	-	310	235	-	100	480	245	G1/2"
	100	913	113	177	487	-	310	-	-	100	480	245	G1/2"
120	1108	113	177	682	-	310	-	-	100	480	245	G1/2"	
505	150	1182	98	-	800	178	440	477	840	230	260	G3/4"	

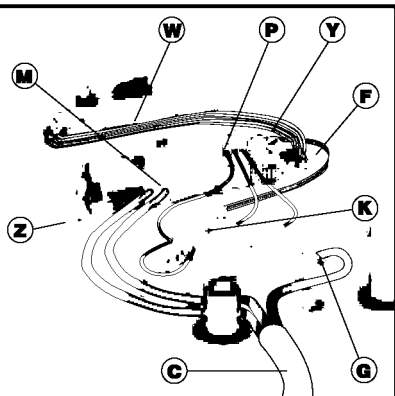
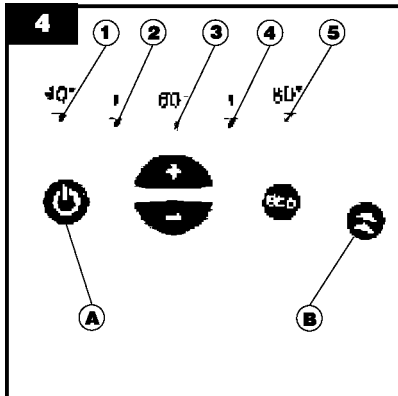
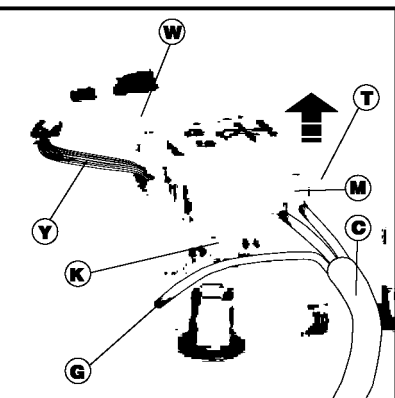
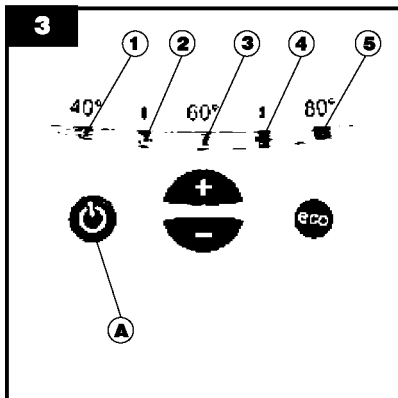
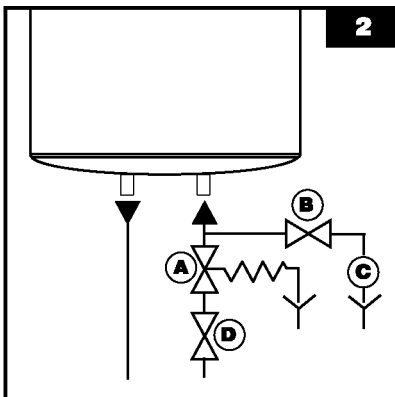
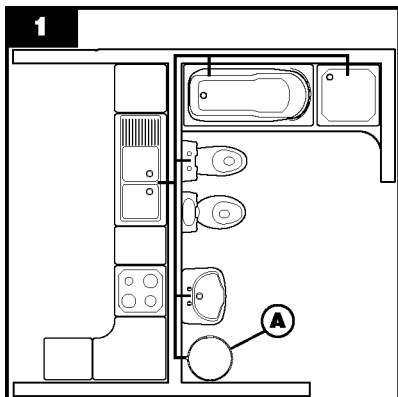

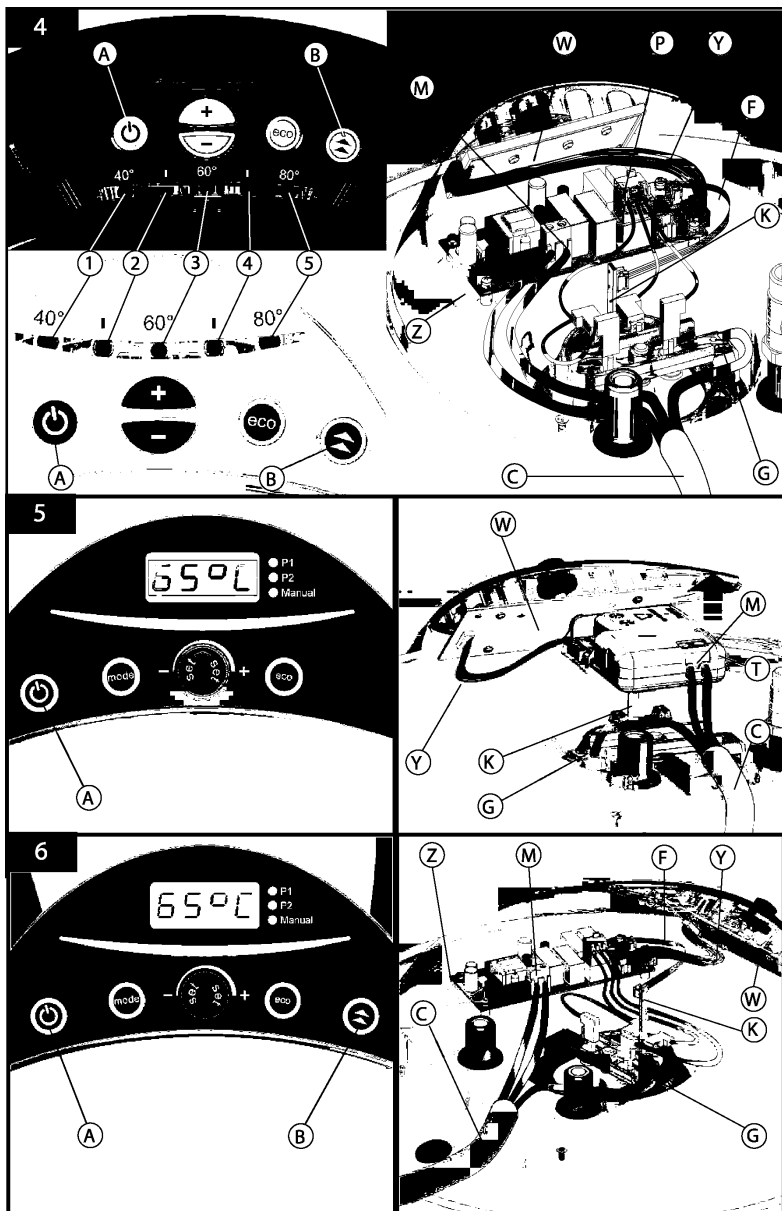

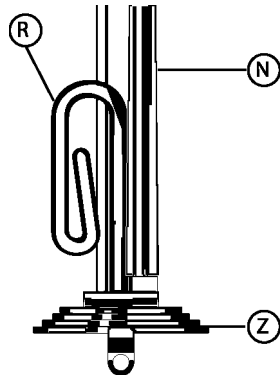
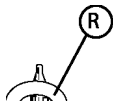
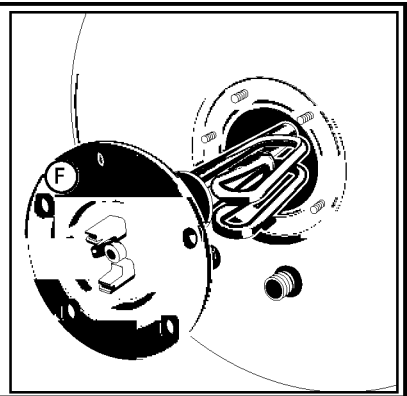
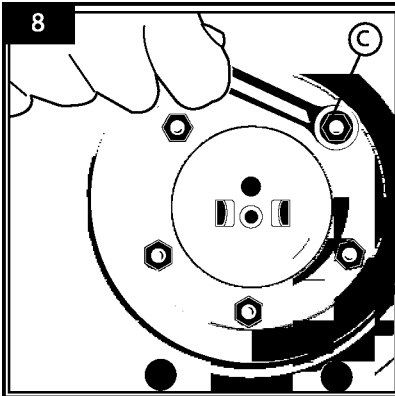
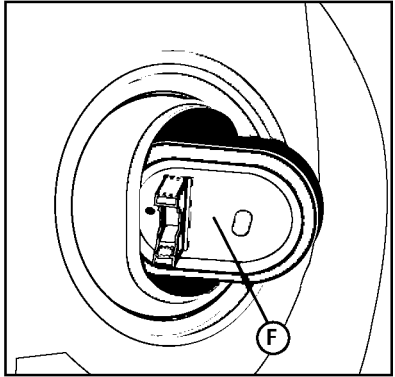
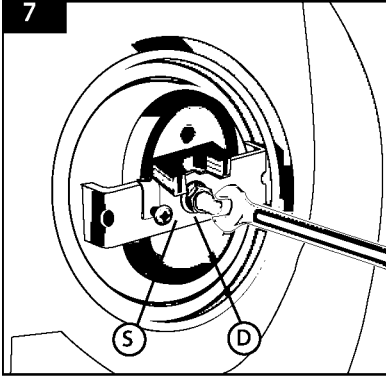

d>

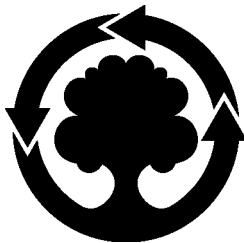

**WE MAKE USE OF  
RECYCLED PAPER**

**Ariston Thermo SpA**

Viale Aristide Merloni, 45

60044 Fabriano (AN)

Tel. 0732.6011

Telefax. 0732.602331

Telex 560160

<http://www.aristonthermo.com>